

Cut your fuel bills with our energy saving

# External Wall Insulation

SAVE ENERGY - SAVE MONEY - STAY WARM

Designed specifically for  
Your Home

With the right insulation  
you can save £££'s...



...and we can help you



**castle point**  
INSULATION LIMITED

## WHY INSULATE?

Insulating walls is a very effective way of reducing the costs of heating your home. As much as 45% of space heat can be lost through solid walls with no insulation.

External Wall Insulation (EWI) will reduce heat loss considerably and can save around £500 per year in heating costs of a typical home (source: Energy Saving Trust).

At the same time, you will have an attractive new and weatherproof exterior that is low maintenance and long lasting, adding value to your home.

## WHAT IS EXTERNAL WALL INSULATION?

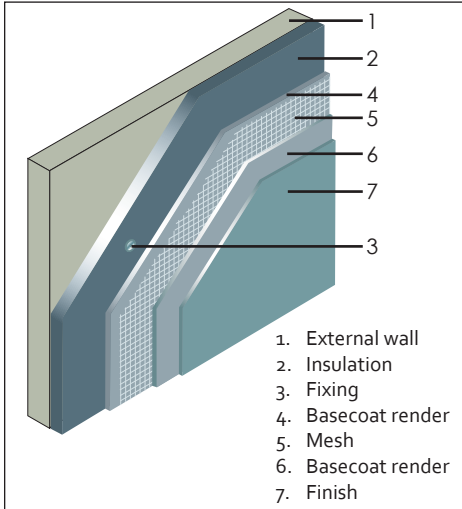

External Wall Insulation is a layer of rigid insulation fixed to the outside walls of a building and covered with a reinforced, weatherproof render coat.

With over 30 year's experience developing systems suitable for all types of buildings, External Wall Insulation systems come with full product guarantees and are Energy Saving Trust Recommended.

A selection of the colours and finishes are available including brick effect render.

## GRANT FUNDING

Grants are available for home energy efficiency improvements so we have developed relationships with the leading Energy Companies to provide funding for domestic refurbishment using External Wall Insulation systems.

**Grants are available to all households and are not means tested.**

## WHY INSULATE EXTERNALLY?

If you own a house without a cavity in the walls, improving its thermal performance means insulating either internally or externally. Using external wall insulation has the following advantages:

- No internal living space is lost as all the insulation is on the outside walls.
- No need to vacate the house whilst works takes place and no need to move furniture and fittings.
- No internal redecoration is required, particularly kitchens and bathrooms.
- Thicker or higher performing insulation can be used resulting in warmer walls.
- The risk of condensation and cold-bridging is eliminated as the whole building is wrapped in insulation.
- An exterior finish is developed which can often closely match the original or surrounding properties.



To arrange a **FREE, NO OBLIGATION SURVEY & QUOTE** please call us on:

# 0844 888 7010



## WHAT IS INVOLVED IN THE INSTALLATION PROCESS?

Carried out by a professional installation company, the following stages will take place:

- A full survey and quotation will be undertaken.
- Samples will be provided for guidance on colour and texture of the finish.
- Scaffolding will be erected for any property over single storey height.
- Fixtures such as satellite dishes, telephone wires, boiler outlets or flues and electricity meters will be adapted or temporarily removed prior to work starting.
- Flashings or extensions to roof verges or eaves may be required to accommodate the system.
- Some noise from drilling will be experienced as insulation boards are fixed to the existing wall.

Most properties will take between one and three weeks to complete depending upon size, complexity and finish.

## EXTERNAL WALL INSULATION

Our External Wall Insulation system has been designed by Structherm Ltd a specialist External Wall Insulation system designer and manufacturer with over 25 years experience in the industry. The system has many benefits for you and the environment.

## SAVE ON YOUR HEATING BILLS

The most significant heat loss in your home is through the external walls. This is estimated to be around 45% of the total heat loss, resulting in high heating bills. By insulating your external walls, you can reduce heat loss and significantly cut your heating bills.

## INCREASED COMFORT LEVELS

Your home will warm up more quickly if insulated and you won't have to keep the heating on for as long to reach a comfortable temperature. Condensation will be a thing of the past and without it less mould growth will occur, leading to a healthier living environment.

## IMPROVED APPEARANCE

With the installation of external wall insulation your home will be transformed with a wide range of contemporary or traditional finishes with a choice of textures, colours and finished effects.

## EASY MAINTENANCE

The high performance render finishes used on the system offer excellent durability and protection against rain, UV rays from sunlight and cracking. Our finishes have the colour pigments added during the mixing process which means they never have to be painted, providing you with a low maintenance home.

## INCREASED PROPERTY VALUE

With a transformation in its appearance and increased thermal performance the value of your home could increase.

## REDUCE YOUR CARBON FOOTPRINT

High levels of heat loss also result in a high carbon footprint, by reducing these levels through insulation you will not only be saving money but helping to protect the environment by reducing carbon emissions.

## QUALITY & SERVICE

For over 40 years Castle Point Insulation has been the South East's leading independent insulation distributor and contractor to the construction industry. The company has a reputation for providing quality installations and a high standard of customer service. Having recognised a need for a solution to the poor thermal performance of Park Homes we have teamed up with Structherm Ltd an innovative system designer with an excellent product range, backed by accreditations and memberships to several high profile organisations along with extensive product guarantees.

- British Board Of Agreement (BBA) Certified
- Energy Saving Trust Recommended
- 10 Year Standard Warranty & Guarantee
- Minimum Design Life of 30 Years
- Member of Insulated Render & Cladding Association (INCA)
- Member of the National Insulation Association



## WHAT SHOULD I DO NEXT

If you are interested in taking your enquiry for External Wall Insulation further, we recommend the following:

- Contact Castle Point Insulation and we should be able to secure grant funding for your home.
- Castle Point will guide you throughout the enquiry and installation processes.



Dorman Long property before the installation of external wall insulation.



Insulation boards fixed to property, first floor completed with acrylic finish.



Completed house with light cream acrylic render to the first floor and brick effect render, with golden buff brick face and charcoal mortar layer, to the ground floor.

To arrange a **FREE, NO OBLIGATION SURVEY & QUOTE** please call us on:

# 0844 888 7010





## OUR TRACK RECORD

We have an excellent track record of externally insulating homes in the South East with over one hundred completed in 2010. This included homes in London, Essex and Sussex amongst others.

## WHAT OUR CUSTOMERS SAY

Mr & Mrs Boulter recently had their home externally insulated with **External Wall Insulation**.

"We approached Castle Point Insulation to find out details about having our Bungalow insulated on the outside. They came to our house and ran through all the options available to us including colour and type of finish and we decided to go ahead just before the very cold winter of 2010/2011."

"We cannot thank Castle Point Insulation enough for a very good job in improving the look of our Bungalow."

"The difference has been amazing as we haven't had to turn up our heating the way we usually do throughout winter as the house was suddenly a lot warmer."

"We thought the workmen from Castle Point Insulation were excellent in their execution of the work, very clean and very quick."



To arrange a **FREE, NO OBLIGATION SURVEY & QUOTE** please call us on:

# 0844 888 7010



## COLOUR OPTIONS

To complete your External Wall Insulation system, you can choose any colour from our standard range of contemporary acrylic renders below. Other colours are available, please call for more details.

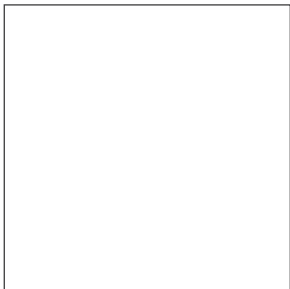

0005

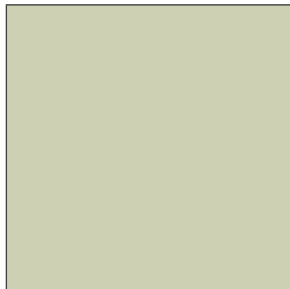

6115

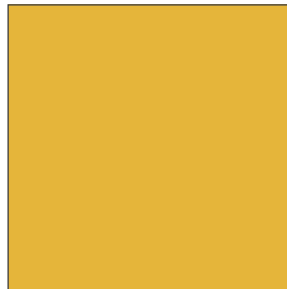

2047

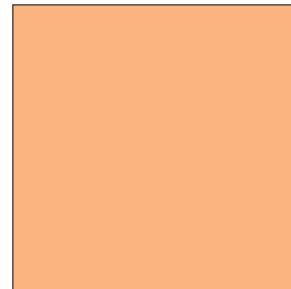

2170

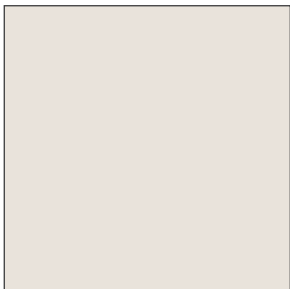

4020



4022

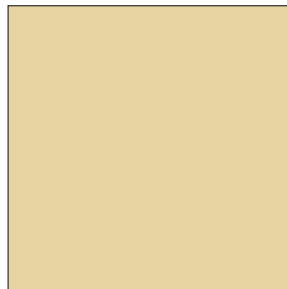

6019

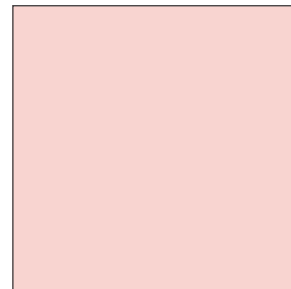

4036

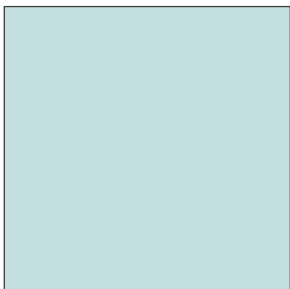

4006



0429



4043

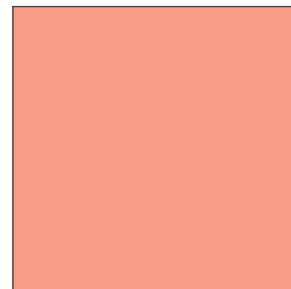

2160

## BRICK EFFECT RENDER

We can also finish your system with a brick effect render, please ask for me details on this option.



Please note that due to the restrictions of the printing process the colours shown are for guidance only. The texture of the acrylic renders also affects the final colour once applied. Always check your colour selection against one of our sample boards.

To arrange a **FREE, NO OBLIGATION SURVEY & QUOTE**  
please call us on:

**0844 888 7010**



## Castle Point Insulation's other products and services include:

- Thermal Insulation
- Acoustic Insulation
- Loft Insulation
- Cavity Wall Insulation
- External Wall Insulation & Render
- Fire Barriers
- Velux Roof Windows
- Solar Panels



**castle point**  
INSULATION LIMITED

in partnership with

  
**Hanson**  
HEIDELBERGCEMENT Group

**Structerm**  
Fastbuild | Cladding | Render

To arrange a **FREE, NO OBLIGATION SURVEY & QUOTE**  
please call us on:

**0844 888 7010**



**Castle Point Insulation Ltd**, Essex House, Josselin Road, Burnt Mills, Basildon, Essex SS13 1EL  
Email: [cpwebsales@essexinsulation.co.uk](mailto:cpwebsales@essexinsulation.co.uk) [www.cpidirect.co.uk](http://www.cpidirect.co.uk)